



Seminole Commons Development
Sanford, Florida

The Center at a Glance

- The Seminole Commons Site is conveniently located at the intersection of Rinehart Road and St. John's Parkway in Sanford, Florida.
- The proposed development will contain a 91,560 SF Retail Center.



Location Map

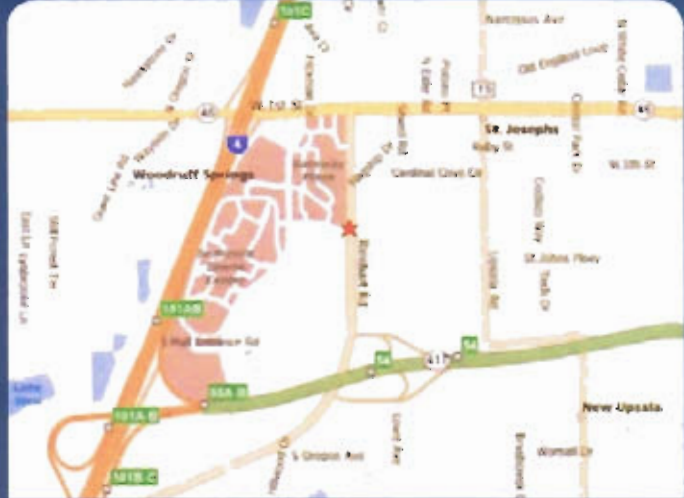

Seminole Commons Development
Rinehart Road at St. John's Parkway
Sanford, FL 32771
tel +1 800 982 6339



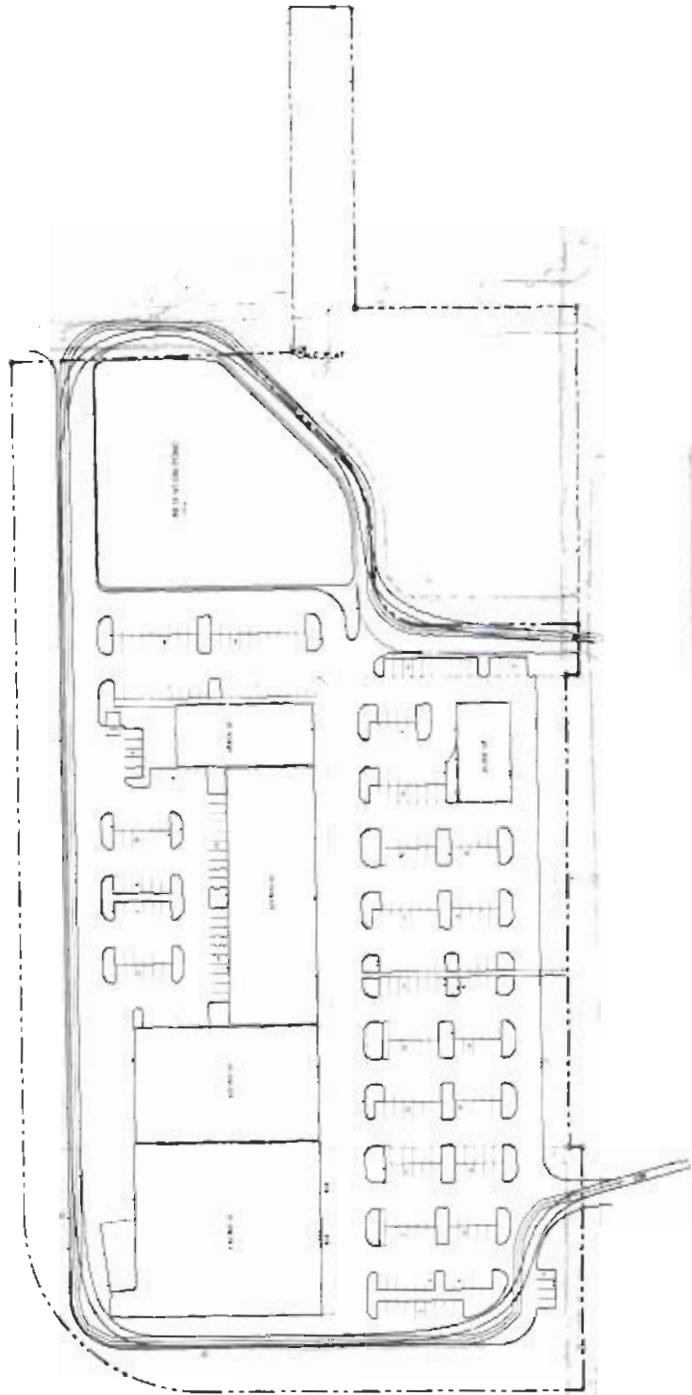

SITE DATA
 TOTAL SQUARE FOOTAGE OF BUILDING PLANNED: 100,000
 TOTAL PARKING SPACES REQUIRED: 100
 TOTAL PARKING SPACES PROVIDED: 100
 TOTAL SQUARE FOOTAGE OF RETAIL SPACE REQUIRED: 0



Concept Plan 2

Demographic Overview

	3 Mile Radius	5 Mile Radius	10 Mile Radius
POPULATION			
2011 Projection	1,967	48,140	117,256
2006 Estimate	1,388	37,733	98,921
Growth 1990 - 2000	33.88%	65.98%	38.88%
INCOME			
Average Household Income	\$58,607	\$81,122	\$70,329
Median Household Income	\$46,474	\$61,836	\$51,415
Per Capita Income	\$25,591	\$32,237	\$27,466
HOUSEHOLDS			
2011 Projection	1,967	48,140	117,256
2006 Estimate	1,388	37,733	98,921
Growth 1990 - 2000	34.76%	71.95%	42.02%
TRAFFIC COUNTS			
SR-46 at Rinehart Road			
41,000 AADT			