

# Shopping Center Spaces

## Brooksville, FL



**\$ 10.00 per Square Foot NNN**

SPECIFICATIONS	
Address.....	20020-20126 Cortez Boulevard (State Road 50) Brooksville, FL 34601
Zoning .....	Commercial
Space Available.....	1,000-62,000 Sq Ft+

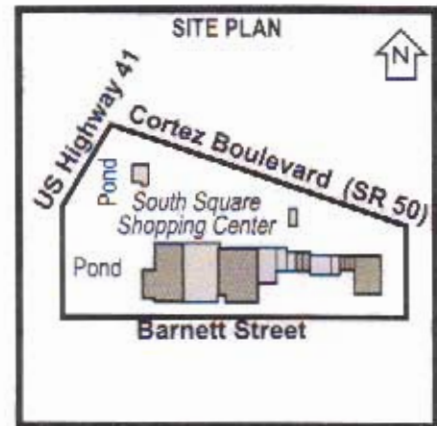

### South Square Shopping Center

- Located at the intersection of SR 50 (Cortez Blvd.) at US 41 (Broad St.) with easy access from all major highways; average daily traffic count 42,600
- Leasing opportunities in the heart of Brooksville, a northern suburb of Tampa in Hernando County
- Spaces available: 1,000, 2,150, 15,000, 29,800 and 62,000± SF
- Current tenants: Walgreens, Big Lots, Napa Auto Parts, Porter Paints, Aaron Rents, Applebee's Bar & Grill and others
- Minutes from newly-opened Sun Coast Parkway and across the street from Super Wal-Mart