

The Village at Lake Lily

Mixed-Use Development
Maitland, Florida

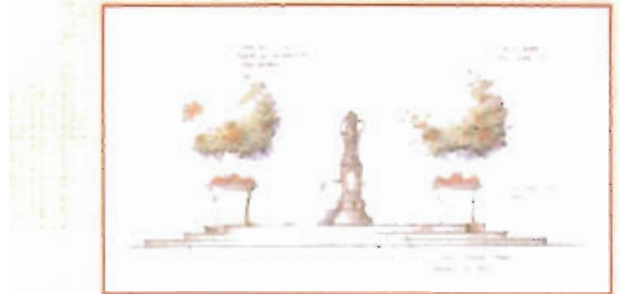

Entry Plaza with Round-A-Bout and Historic Citrus Pump

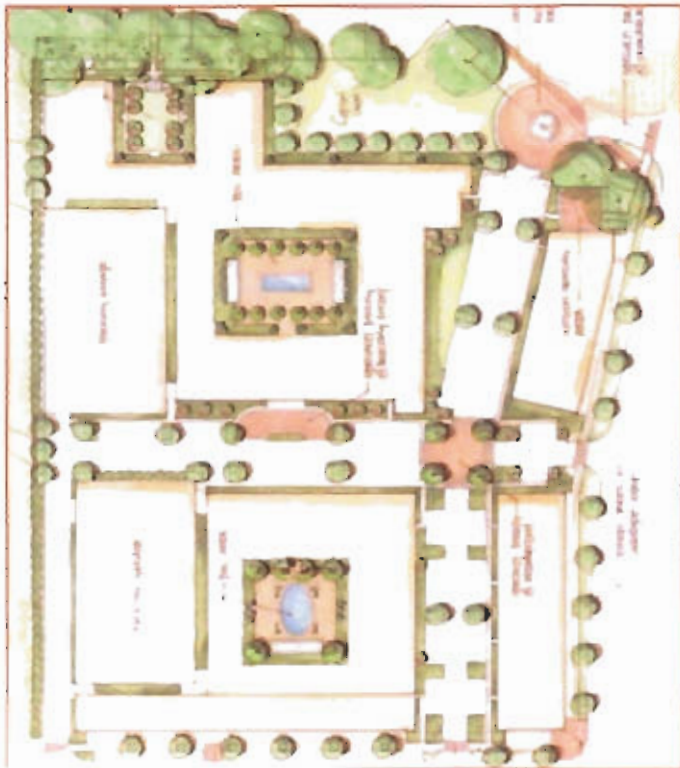

Outdoor Dining Patio with View of Lake Lily

The Village at Lake Lily

Mixed-Use Development
Maitland, Florida

Property Highlights

- Vibrant mixed-use development
- 455 Residential Multi Family units
- 40,000 square feet of ground floor Retail
- Located adjacent to Lake Lily Park where over 50 community events are held throughout the year
- Exceptional visibility from Orlando Avenue (17/92)
- Retail vacancy rate of 4.5% in Maitland
- High growth area- significant increase in population of 34,508 people over the past six years (from 332,139 to 366,647)



Gateway Plaza at Lake Avenue and Orlando Avenue

Location Map

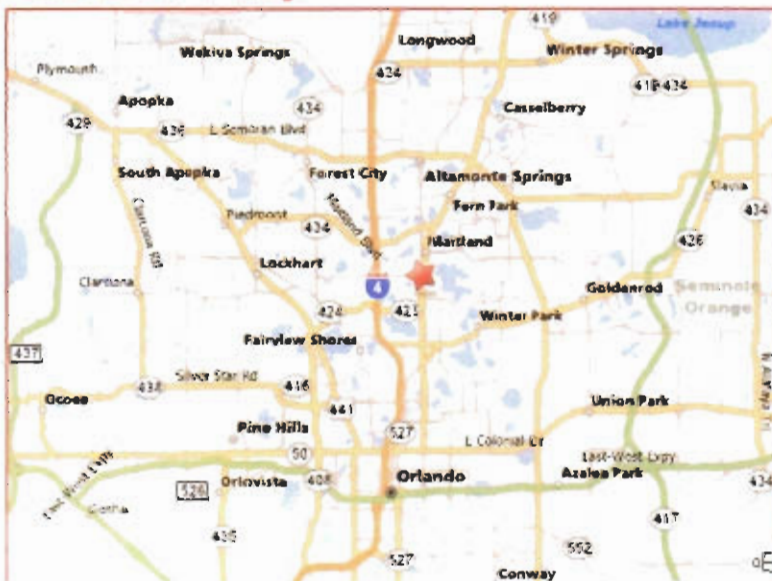

Demographics

| | <u>1 Mile</u> | <u>3 Mile</u> | <u>5 Mile</u> |
|--------------|---------------|---------------|---------------|
| Population: | 8,837 | 93,309 | 253,713 |
| Avg. Income: | \$95,033 | \$79,305 | \$67,422 |
| Median Age | 41.8 | 41.5 | 39.5 |

Traffic Counts

54,500 Vehicles per day at the intersection of Orlando Avenue (17/92) & Lake Avenue